

Linear Axis - LA120-BS

Parameter	Value	Unit
Motor Holding Torque	7	Nm
Ball Screw Diameter	16	mm
Screw Lead	10	mm/rot
Max Vertical Load	100	kg
Max Vertical Load	50	kg
No load speed	400	mm/s
Max Horizontal Speed	360	mm/s
Max Vertical Speed	270	mm/s
Rated Acceleration	1000	mm/s ²
Position Accuracy	0.05	mm
Max Force	1572	N
Service Life	20 000	km

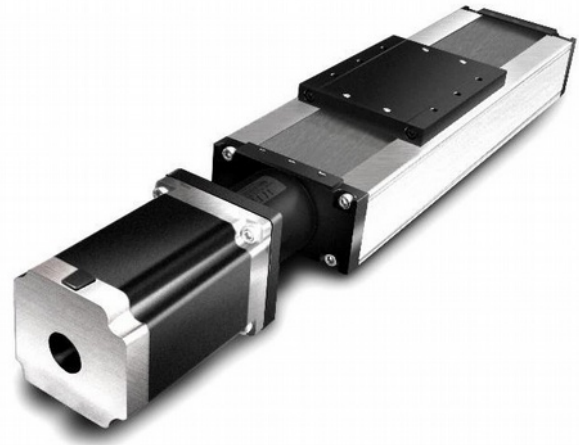

Dynamic Permissible Torque
 Ma=550Nm Mb=390Nm Mc=390Nm

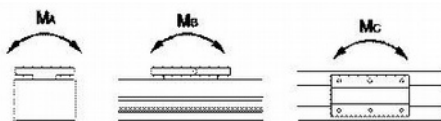

Linear Axis LA120-BS-400-10-C5 - Order Code Example

LA = Linear Axis

Axis Width

120 = 120 mm axis width

Screw and Belt linear module

BS=Ball Screw linear module
 BL=Belt linear module
 PBS=Precise screw
 DBL=Double-rail belt
 HND=Hand-wheel screw

Effective Stroke

100-2000mm Screw linear module
 100-4000mm Belt Linear Module

Screw lead mm/rot

05 mm
 10 mm
 16 mm
 20 mm

Screw accuracy class

C5
 C7

LA120-BS Dimensions

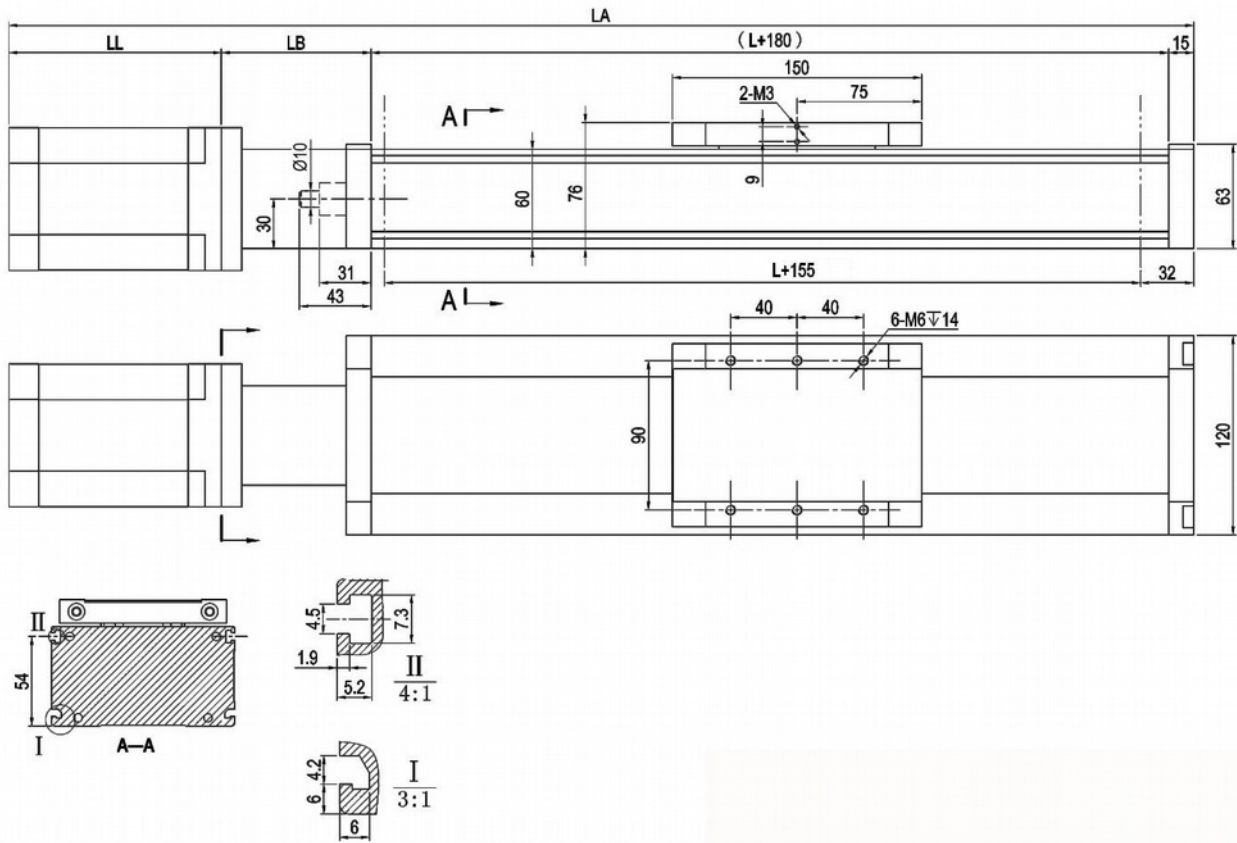

	LB	LL	LA
NEMA34 Stepper Motor	90	128	L+413
400W Servomotor	80	130	L+405
750W Servomotor	103	138	L+436

Stroke (mm)	100	200	300	400	500	600	700	800	900	1000
Linear Axis Total Length (mm)	513	613	713	813	913	1013	1113	1213	1313	1413
Weight (kg)	12.2	13.4	14.6	15.8	17	18.3	19.5	20.7	22	23.2

Stroke (mm)	1100	1200	1300	1400	1500	1600	1700	1800	1900	2000
Linear Axis Total Length (mm)	1513	1613	1713	1813	1913	2013	2113	2213	2313	2413
Weight (kg)	24.4	25.7	26.9	28.1	29.4	31.2	32.4	33.8	35	36.3

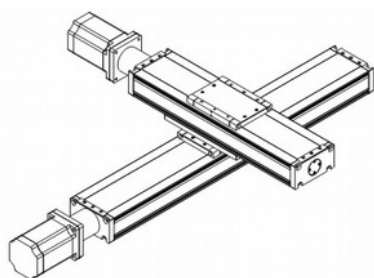

LA 120 XY- X

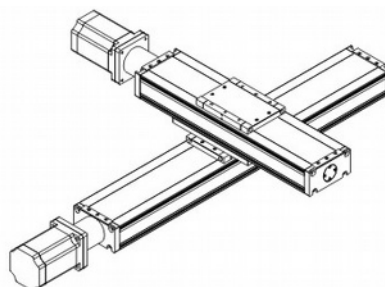

LA 120 XY - S

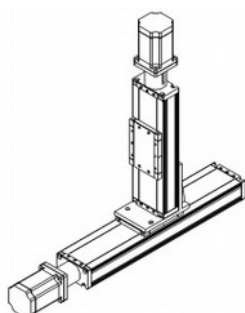

LA 120 XY - T



Example LA120XY-T

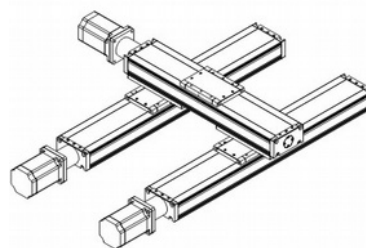

LA 120 XY - H1

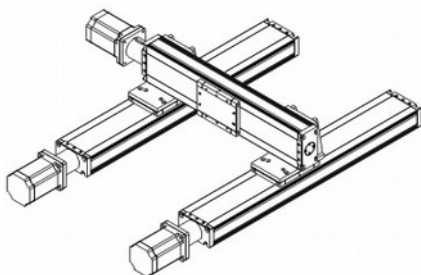

LA 120 XY - H2

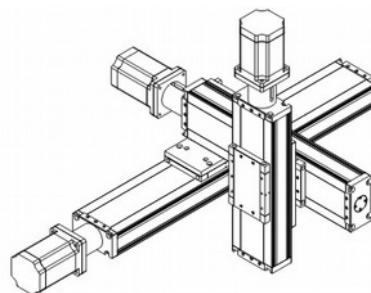

LA 120 XYZ - X

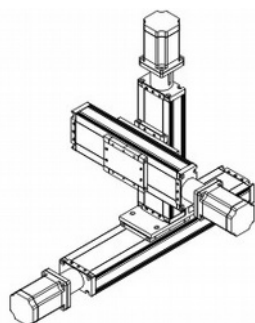

LA 120 XYZ - T

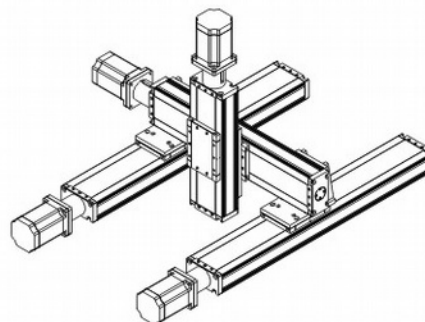

LA 120 XYZ - L